

455564 209427 455664 209427 455764 209427 455864 209427 455964 209427 456064 209427 456164 209427 456264 209427 456364 209427 456464 209427

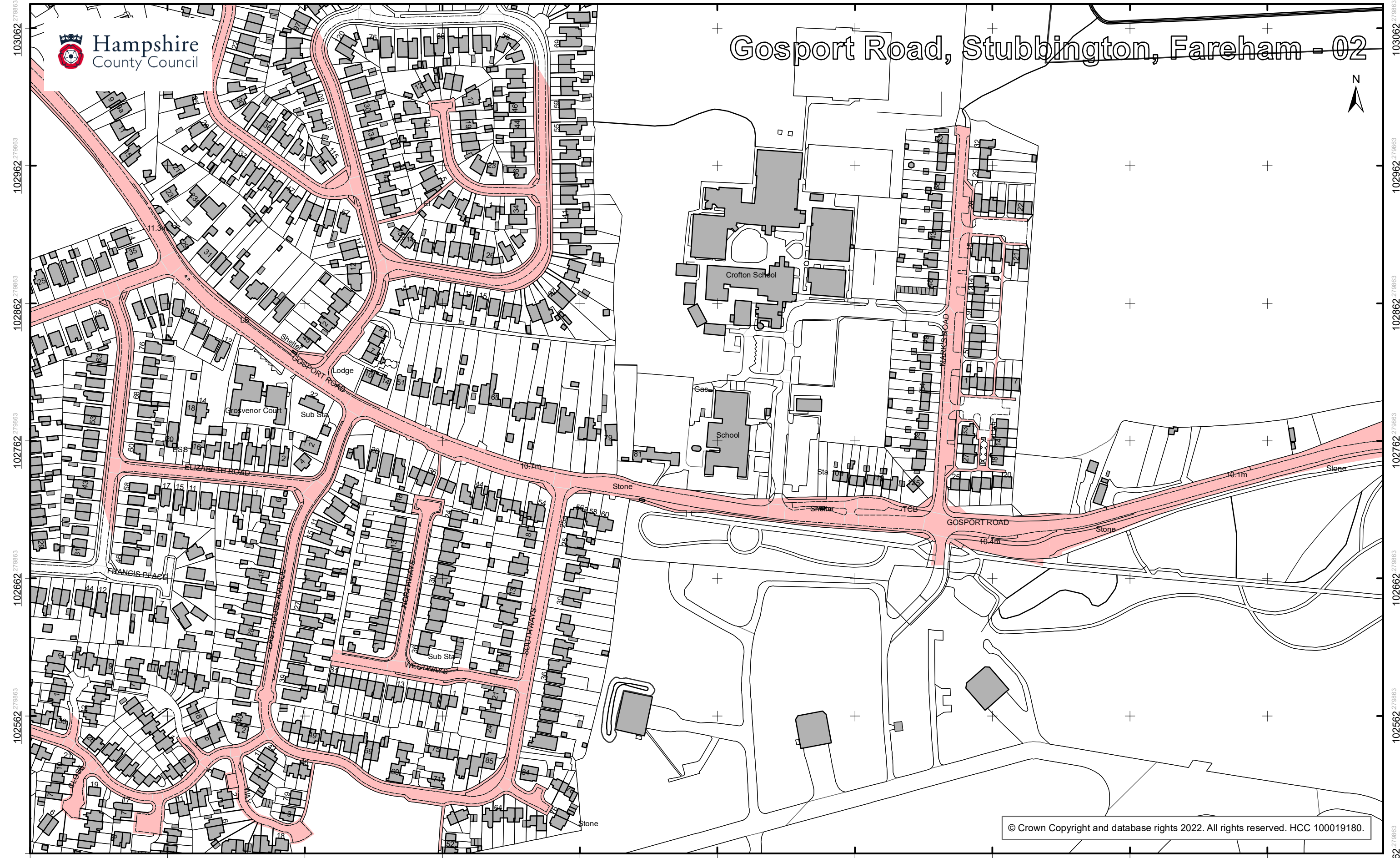

Gosport Road, Stubbington, Fareham - 02



103062 102962 102862 102762 102662 102562

103062 102962 102862 102762 102662 102562

455564 209427 455664 209427 455764 209427 455864 209427 455964 209427 456064 209427 456164 209427 456264 209427 456364 209427 21608191 02 456464 209427 MW

© Crown Copyright and database rights 2022. All rights reserved. HCC 100019180.

Ordnance Survey maps are topographic maps and show a representation of the physical features on the ground at the time of survey, which are drawn according to specified tolerances, by the Ordnance Survey. For further information on Ordnance Survey mapping please see: <http://www.ordnancesurvey.co.uk/support/property-boundaries.html>

For questions about the responsibility for ditches please refer to Hampshire County Council's website at: <http://documents.hants.gov.uk/flood-water-management/ditchmaintenanceposter.pdf>

This plan is made on the basis of information at present available to the County Council and is made on the distinct understanding that, in the absence of negligence, neither the County Council nor I as an officer of the Council is to be held responsible should you rely on this statement and consequently suffer damage